

MANUFACTURERS • DISTRIBUTORS • IMPORTERS



Global Water Group

PE Pipe, Fitting and Valve Specialists

Electrofusion Catalogue

Civil • Industrial • Construction • Mining

Agriculture • Aquaculture • Grazier



Why Choose Our Electrofusion Fittings?

Our electrofusion fittings represent the highest quality and excellence in electrofusion production throughout the world. PlastItalia fittings are WSAA approved and suitable for water, gas and industrial fluids. Our extensive range includes couplers, tees, reducing tees, elbows, reducers and tapping saddles. Sizes range from 20mm - 1200mm.

- PE100 black
- Working voltage 39.5 - 48V
- Injection moulded

Suitable for piping systems for:

- Water distribution (UNI EN 12201 - ISO 4427) up to PN25 bar
- Industrial applications (UNI EN ISO 15494)
- Distribution of fuel gas (UNI EN 1555 - ISO 4437)



Electrofusion products symbols reference:

 Item for drinking water application

 Item for industrial application

 Item for fuel gas application

 Item for fuel gas application



GWG WELDING WIPES

These specialised moist wipes are impregnated with a high specification solution containing 90% V/V Isopropyl Alcohol.

Ensure surfaces are clean before butt or electrofusion jointing (scraping of pipe surface is still required). 75 sheets per canister.

Electrofusion Tooling - Control Units

iPlast Control Units are the result of precise research at PlastItalia. They are made to make the welds of pipe and fittings for water and fuel gas more trustworthy and secure. The meticulous research and attention to detail have given life to this sophisticated device, whose internal control system and safety mechanisms are able to guarantee an optimal welding and in conditions of total safety for operators.

The new control unit, iPlast, houses a world-leading internal electronic unit, suitable for small dimensions — an outcome of a new generation of technological developments that PlastItalia, as first in the electrofusion fittings market, has brought.



Electrofusion Tee

SDR11    

dn (mm)	Code	H (mm)	Z (mm)	Weight (kg)
20	EFT11020	65	98	0.06
25	EFT11025	65	98	0.08
32	EFT11032	50	116	0.1
40	EFT11040	56	130	0.15
50	EFT11050	56	149	0.24
63	EFT11063	69	175	0.46
75	EFT11075	69	188	0.64
90	EFT11090	84	211	1.03
110	EFT11110	90	250	1.8
125	EFT11125	90	265	2.42
140	EFT11140	91	292	3.06
160	EFT11160	100	319	4.53
180	EFT11180	105	355	5.98
200	EFT11200	115	415	8.45
225	EFT11225	115	415	11.03
250	EFT11250	133	478	17
315	EFT11315	153	560	30.34

Electrofusion Reducing Tee

SDR11    

dn (mm)	dn1 (mm)	Code	H (mm)	Z (mm)	Weight (kg)
90	63	EFTR11090063	65	211	0.92
90	75	EFTR11090075	67	211	0.98
110	63	EFTR11110063	67	249	1.48
125	63	EFTR11125063	65	265	2.08
125	90	EFTR11125090	81	265	2.18
140	110	EFTR11140110	84	292	2.82
160	110	EFTR11160110	88	319	4.17
180	90	EFTR11180090	85	336	5.38
180	125	EFTR11180125	93	336	5.48
200	90	EFTR11200090	83	415	7.56
200	125	EFTR11200125	88	415	7.73
200	180	EFTR11200180	107	415	7.96
225	110	EFTR11225110	89	415	10
225	160	EFTR11225160	100	415	10.38
250	125	EFTR11250125	93	478	14.95
250	180	EFTR11250180	110	478	15.58
315	125	EFTR11315125	93	560	25.72
315	180	EFTR11315180	110	560	27.42

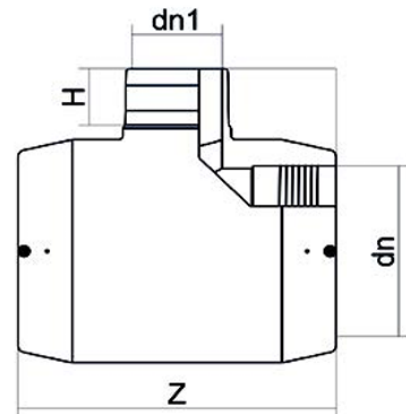
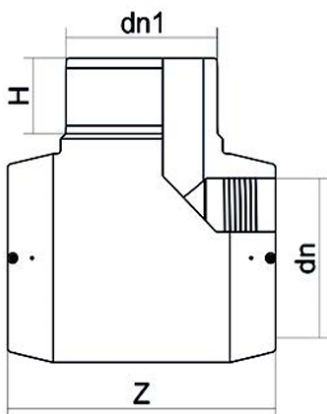

Electrofusion Coupler

SDR26   

dn (mm)	Code	DE (mm)	Z (mm)	Weight (kg)
280	EFC26280	323	231	3.32
315	EFC26315	360	251	3.57
355	EFC26355	406	289	5.04
400	EFC26400	462	304	7.79
450	EFC26450	513	387	11.78
500	EFC26500	570	385	20.25
560	EFC26560	635	455	25.5
630	EFC26630	690	439	24.5
710	EFC26710	776	450	32.65
800	EFC26800	872	455	39.2
900	EFC26900	982	500	59
1000	EFC261000	1096	500	71
1200	EFC261200	1335	465	90

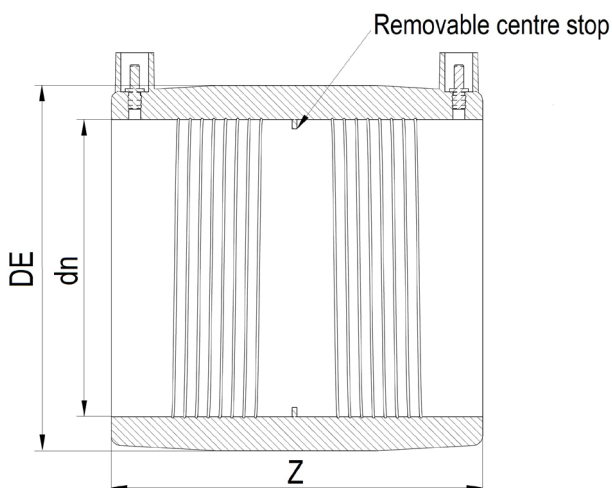
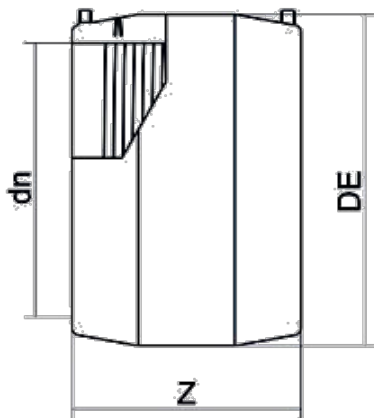

SDR17    

dn (mm)	Code	DE (mm)	Z (mm)	Weight (kg)
90	EFC17090	106	130	0.29
110	EFC17110	129	150	0.48
125	EFC17125	155	156	0.88
140	EFC17140	173	172	1.14
160	EFC17160	185	184	1
180	EFC17180	220	190	2.02
200	EFC17200	229	209	1.73
225	EFC17225	259	226	2.37
250	EFC17250	288	246	3.32
280	EFC17280	323	231	3.57
315	EFC17315	360	251	5.04
355	EFC17355	406	289	7.79
400	EFC17400	462	304	11.75
450	EFC17450	508	382	14
500	EFC17500	570	386	20.25
560	EFC17560	642	455	25.5
630	EFC17630	718	502	35.3
710	EFC17710	814	500	55.6
800	EFC17800	916	500	80.2
900	EFC17900	1030	520	82.2
1000	EFC171000	1144	536	105
1100	EFC171100	1240	540	131.4
1200	EFC171200	1365	600	178.5



SDR11



dn (mm)	Code	DE (mm)	Z (mm)	Weight (kg)
20	EFC11020	29	70	0.03
25	EFC11025	34	74	0.44
32	EFC11032	44	85	0.07
40	EFC11040	54	92	0.1
50	EFC11050	66	97	0.14
63	EFC11063	78	113	0.18
75	EFC11075	95	120	0.27
90	EFC11090	112	129	0.39
110	EFC11110	136	150	0.62
125	EFC11125	155	160	0.88
140	EFC11140	173	170	1.14
160	EFC11160	197	185	1.52
180	EFC11180	220	190	2.02
200	EFC11200	246	210	2.82
225	EFC11225	277	226	3.57
250	EFC11250	310	245	4.85
280	EFC11280	345	250	6.85
315	EFC11315	390	265	8.79
355	EFC11355	438	302	13.22
400	EFC11400	495	355	18.9
450	EFC11450	554	425	26.47
500	EFC11500	610	460	34
560	EFC11560	696	500	54.38
630	EFC11630	780	505	65.1
710	EFC11710	868	530	76
800	EFC11800	975	520	96
900	EFC11900	1120	552	161

SDR7.4



dn (mm)	Code	DE (mm)	Z (mm)	Weight (kg)
32	EFC07.4032	44	85	0.07
40	EFC07.4040	54	94	0.11
50	EFC07.4050	68	99	0.16
63	EFC07.4063	88	115	0.31
75	EFC07.4075	106	120	0.46
90	EFC07.4090	125	132	0.46
110	EFC07.4110	145	150	0.94
125	EFC07.4125	174	166	1.54
140	EFC07.4140	193	170	2.06
160	EFC07.4160	220	202	2.78
180	EFC07.4180	244	200	3.36
200	EFC07.4200	276	232	4.6
225	EFC07.4225	305	252	7.14
250	EFC07.4250	341	266	8.62
280	EFC07.4280	388	272	12.81
315	EFC07.4315	435	302	18.56
355	EFC07.4355	495	358	28.9
400	EFC07.4400	574	385	43
450	EFC07.4450	635	455	36.3
500	EFC07.4500	678	450	59

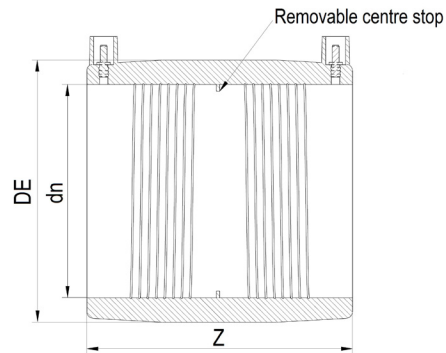
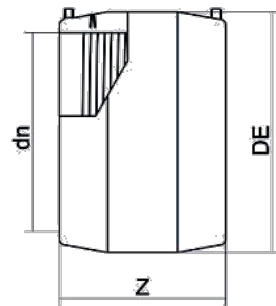

Electrofusion 90° Elbow

SDR11    

dn (mm)	Code	Z (mm)	Weight (kg)
20	EFE9011020	63	0.15
25	EFE9011025	60	0.7
32	EFE9011032	57	0.1
40	EFE9011040	68	0.16
50	EFE9011050	78	0.2
63	EFE9011063	94	0.31
75	EFE9011075	103	0.49
90	EFE9011090	116	0.75
110	EFE9011110	141	1.36
125	EFE9011125	155	1.81
140	EFE9011140	167	2.54
160	EFE9011160	181	3.67
180	EFE9011180	219	5.66
200	EFE9011200	241	7.8
225	EFE9011225	259	10.28
250	EFE9011250	316	12.59
315	EFE9011315	383	23.46

Electrofusion 45° Elbow

SDR11    

dn (mm)	Code	Z (mm)	Weight (kg)
20	EFE9011020	63	0.15
25	EFE9011025	60	0.7
32	EFE9011032	57	0.1
40	EFE9011040	68	0.16
50	EFE9011050	78	0.2
63	EFE9011063	94	0.31
75	EFE9011075	103	0.49
90	EFE9011090	116	0.75
110	EFE9011110	141	1.36
125	EFE9011125	155	1.81
140	EFE9011140	167	2.54
160	EFE9011160	181	3.67
180	EFE9011180	219	5.66
200	EFE9011200	241	7.8
225	EFE9011225	259	10.28
250	EFE9011250	316	12.59
315	EFE9011315	383	23.46

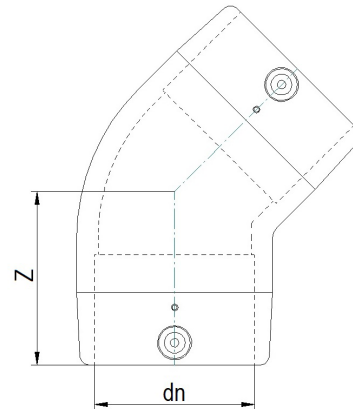
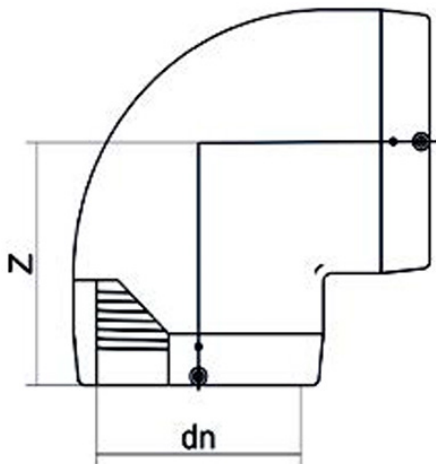

Electrofusion 22.5° Elbow

SDR11    

dn (mm)	Code	Z (mm)	Weight (kg)
90	EFE22.511090	95	0.66
125	EFE22.511125	110	1.46
180	EFE22.511180	140	3.84
250	EFE22.511250	160	6.16
315	EFE22.511315	185	12.06

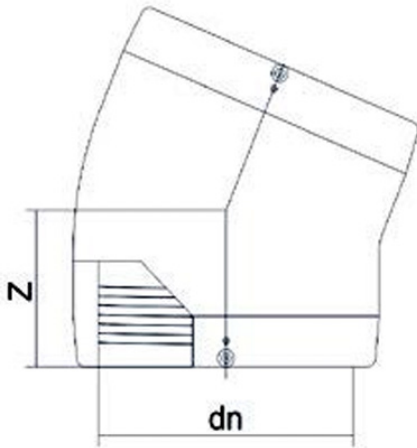

Electrofusion 11.25° Elbow

SDR11    

dn (mm)	Code	Z (mm)	Weight (kg)
90	EFE11.2511090	86	0.66
125	EFE11.2511125	110	1.46
180	EFE11.2511180	140	3.64
250	EFE11.2511250	160	5.09
315	EFE11.2511315	185	9.95

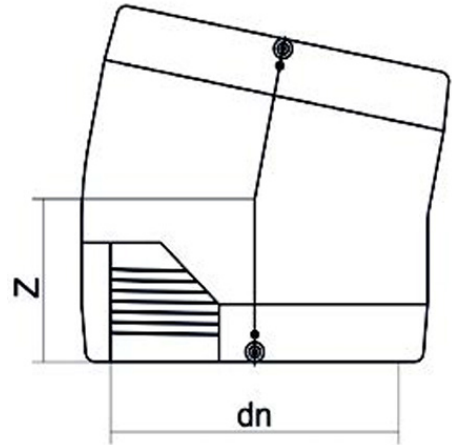

GWG WELDING WIPES

These specialised moist wipes are impregnated with a high specification solution containing 90% V/V Isopropyl Alcohol.

Ensure surfaces are clean before butt or electrofusion jointing (scraping of pipe surface is still required). 75 sheets per canister.



Electrofusion Branch Saddle

SDR11    

dn (mm)	dn1 (mm)	Code	H (mm)	Weight (kg)
40	20	EFBS11040020	60	0.16
40	25	EFBS11040025	60	0.16
40	32	EFBS11040032	60	0.16
50	20	EFBS11050020	60	0.16
50	25	EFBS11050025	60	0.16
50	32	EFBS11050032	60	0.16
50	40	EFBS11050040	60	0.17
63	20	EFBS11063020	60	0.19
63	25	EFBS11063025	60	0.19
63	32	EFBS11063032	60	0.19
63	40	EFBS11063040	60	0.2
63	50	EFBS11063050	75	0.3
63	63	EFBS11063063	75	0.4
75	20	EFBS11075020	60	0.22
75	25	EFBS11075025	60	0.22
75	32	EFBS11075032	60	0.22
75	40	EFBS11075040	60	0.23
75	50	EFBS11075050	65	0.49
75	63	EFBS11075063	65	0.53
90	20	EFBS11090020	60	0.22
90	25	EFBS11090025	60	0.22
90	32	EFBS11090032	60	0.22
90	40	EFBS11090040	60	0.23
90	50	EFBS11090050	65	0.49
90	63	EFBS11090063	75	0.29
90	90	EFBS11090090	100	1.07
110	20	EFBS11110020	60	0.25
110	25	EFBS11110025	60	0.25
110	32	EFBS11110032	60	0.25
110	40	EFBS11110040	60	0.26
110	50	EFBS11110050	65	0.49
110	63	EFBS11110063	90	0.4
110	75	EFBS11110075	90	0.94
110	90	EFBS11110090	90	0.43
125	20	EFBS11125020	60	0.25
125	25	EFBS11125025	60	0.25
125	32	EFBS11125032	60	0.25
125	40	EFBS11125040	60	0.26

dn (mm)	dn1 (mm)	Code	H (mm)	Weight (kg)
125	50	EFBS11125050	65	0.49
125	63	EFBS11125063	90	0.43
125	75	EFBS11125075	90	0.93
125	90	EFBS11125090	90	0.5
140	20	EFBS11140020	60	0.26
140	25	EFBS11140025	60	0.26
140	32	EFBS11140032	60	0.26
140	40	EFBS11140040	60	0.27
140	50	EFBS11140050	65	0.49
140	63	EFBS11140063	65	0.53
140	75	EFBS11140075	90	0.96
140	90	EFBS11140090	90	0.94
160	20	EFBS11160020	60	0.34
160	25	EFBS11160025	60	0.34
160	32	EFBS11160032	60	0.34
160	40	EFBS11160040	65	0.36
160	50	EFBS11160050	65	0.5
160	63	EFBS11160063	90	0.62
160	75	EFBS11160075	90	0.95
160	90	EFBS11160090	90	0.7
180/200	90	EFBS11180/200090*	90	1.06
180	20	EFBS11180020	60	0.34
180	25	EFBS11180025	60	0.34
180	32	EFBS11180032	60	0.34
180	40	EFBS11180040	65	0.36
180	50	EFBS11180050	65	0.5
180	63	EFBS11180063	90	0.7
180	75	EFBS11180075	90	0.95
200	20	EFBS11200020	60	0.34
200	25	EFBS11200025	60	0.35
200	32	EFBS11200032	60	0.36
200	40	EFBS11200040	65	0.37
200	50	EFBS11200050	65	0.5
200	63	EFBS11200063	90	0.72
200	75	EFBS11200075	90	0.96
225/280	63	EFBS11225/280063*	90	1.06
225/280	75	EFBS11225/280075*	90	1.06
225/280	90	EFBS11225/280090*	90	1.06



Electrofusion Branch Saddle

SDR11    

dn (mm)	dn1 (mm)	Code	H (mm)	Weight (kg)
225	20	EFBS11225020	65	0.49
225	25	EFBS11225025	65	0.49
225	32	EFBS11225032	65	0.45
225	40	EFBS11225040	65	0.49
225	50	EFBS11225050	75	0.46
250	20	EFBS11250020	65	0.47
250	25	EFBS11250025	65	0.5
250	32	EFBS11250032	65	0.49
250	40	EFBS11250040	65	0.49
250	50	EFBS11250050	65	0.51
280	20	EFBS11280020	65	0.49
280	25	EFBS11280025	65	0.51
280	32	EFBS11280032	65	0.5
280	40	EFBS11280040	65	0.53
280	50	EFBS11280050	65	0.52
315/450	63	EFBS11315/450063*	90	1.08
315/450	75	EFBS11315/450075*	90	1.08
315/450	90	EFBS11315/450090*	90	1.08
315	20	EFBS11315020	65	-
315	25	EFBS11315025	65	0.48
315	32	EFBS11315032	65	0.49
315	40	EFBS11315040	65	0.51
315	50	EFBS11315050	65	0.53
500/900	63	EFBS11500/900063*	90	1.74
500/900	75	EFBS11500/900075*	90	1.74
500/900	90	EFBS11500/900090*	90	1.74

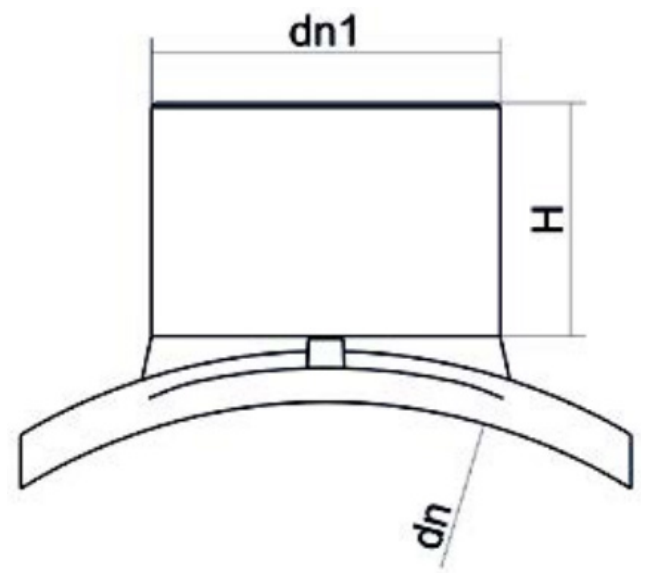

* Installation with belts and ratchets, as shown in picture below



Electrofusion Branch Saddle - High Volume

SDR11 

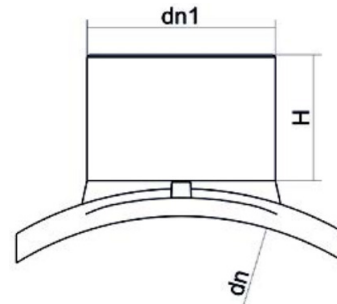

dn (mm)	dn1 (mm)	Code	H (mm)	Weight (kg)
125	110	EFBS11125110	90	1.38
160	110	EFBS11160110	90	0.8
160	125	EFBS11160125	110	1.67
180	110	EFBS11180110	110	2.11
180	125	EFBS11180125	98	1.63
200/225	110	EFBS11200/225110	110	1
200/225	125	EFBS11200/225125	110	1
250/280	110	EFBS11250/280110	110	1
250/280	125	EFBS11250/280125	110	1
315/400	110	EFBS11315/400110	110	2
315/400	125	EFBS11315/400125	110	2.1
315/400	160	EFBS11315/400160	110	2.5
315	200	EFBS11315200*	150	3.9
315	225	EFBS11315225*	150	4.8
355	200	EFBS11355200*	150	4.2
355	225	EFBS11355225*	150	4.9
400	200	EFBS11400200*	150	5.4
400	225	EFBS11400225*	150	6
450/500	110	EFBS11450/500110	110	2
450/500	125	EFBS11450/500125	110	2.1
450/500	160	EFBS11450/500160	110	2.5
450	200	EFBS11450200*	150	4.5
450	225	EFBS11450225*	150	5.7
450	250	EFBS11450250*	150	6.8
500	200	EFBS11500200*	150	5
500	225	EFBS11500225*	150	5.6
500	250	EFBS11500250*	150	6.7
560/630	110	EFBS11560/630110	110	2
560/630	125	EFBS11560/630125	110	2.1
560/630	160	EFBS11560/630160	110	2.5
560	200	EFBS11560200*	150	4.9
560	225	EFBS11560225*	160	5.5
560	250	EFBS11560250*	150	6.4
560	315	EFBS11560315*	200	12.5
630	200	EFBS11630200*	150	4.9
630	225	EFBS11630225*	150	5.5
630	250	EFBS11630250*	150	6.5
630	315	EFBS11630315*	200	12.5

dn (mm)	dn1 (mm)	Code	H (mm)	Weight (kg)
710/800	110	EFBS11710/800110	110	2
710/800	125	EFBS11710/800125	110	2.1
710/800	160	EFBS11710/800160	110	2.5
710	200	EFBS11710200*	150	4.8
710	225	EFBS11710225*	150	5.3
710	250	EFBS11710250*	150	6.5
710	315	EFBS11710315*	200	12.5
800	200	EFBS11800200*	150	4.6
800	225	EFBS11800225*	150	5.3
800	250	EFBS11800250*	150	6.5
800	315	EFBS11800315*	200	12.5
900/1000	110	EFBS11900/1000110	110	2
900/1000	125	EFBS11900/1000125	110	2.1
900/1000	160	EFBS11900/1000160	110	-
900	200	EFBS11900200*	150	4.5
900	225	EFBS11900225*	150	5.3
900	250	EFBS11900250*	150	6.5
900	315	EFBS11900315*	200	12.5
1000	200	EFBS111000200*	150	4.4
1000	225	EFBS111000225*	150	5.3
1000	250	EFBS111000250*	150	6.5
1000	315	EFBS111000315*	200	12.5
1200	200	EFBS111200200*	150	5.1
1200	225	EFBS111200225*	150	5.5
1200	250	EFBS111200250*	150	6.5
1200	315	EFBS111200315*	200	12.5

* Top loading clamp needed to install this product

Electrofusion Reducer

SDR11    

dn (mm)	dn1 (mm)	Code	Z (mm)	Weight (kg)
25	20	EFCR11025020	77	0.04
32	20	EFCR11032020	85	0.077
32	25	EFCR11032025	77	0.05
40	20	EFCR11040020	120	0.09
40	25	EFCR11040025	109	0.11
40	32	EFCR11040032	95	0.012
50	25	EFCR11050025	120	0.13
50	32	EFCR11050032	100	0.14
50	40	EFCR11050040	103	0.17
63	25	EFCR11063025	145	0.17
63	32	EFCR11063032	118	0.2
63	40	EFCR11063040	118	0.22
63	50	EFCR11063050	118	0.23
75	50	EFCR11075050	142	0.38
75	63	EFCR11075063	143	0.31
90	50	EFCR11090050	179	0.45
90	63	EFCR11090063	162	0.45
90	75	EFCR11090075	148	0.43
110	63	EFCR11110063	210	0.76
110	75	EFCR11110075	186	0.73
110	90	EFCR11110090	178	0.78
125	63	EFCR11125163	226	1
125	90	EFCR11125190	194	1.04
125	110	EFCR11125110	179	1.04
140	90	EFCR11140090	212	1.3
160	90	EFCR11160090	251	1.78
160	110	EFCR11160110	243	1.95
160	125	EFCR11160125	244	2
180	90	EFCR11180090	289	2.5
180	125	EFCR11180125	244	2.43
180	140	EFCR11180140	246	2.59
180	160	EFCR11180160	230	2.62
200	160	EFCR11200160	275	3.6
200	180	EFCR11200180	246	3.36
225	160	EFCR11225160	314	5.7
250	180	EFCR11250180	318	6.2
315	200	EFCR11315200	414	11.6

Electrofusion End Cap

SDR11    

dn (mm)	Code	H (mm)	Z (mm)	Weight (kg)
20	EFCAP11020	53	92	0.04
25	EFCAP11025	40	49	0.05
32	EFCAP11032	36	49	0.07
40	EFCAP11040	64	110	0.14
50	EFCAP11050	46	61	0.12
63	EFCAP11063	82	139	0.28
75	EFCAP11075	87	148	0.43
90	EFCAP11090	102	167	0.63
110	EFCAP11110	104	180	1.07
125	EFCAP11125	110	189	1.39
140	EFCAP11140	114	200	2.04
160	EFCAP11160	130	224	2.62
180	EFCAP11180	122	218	2.98
200	EFCAP11200	157	263	4.79
225	EFCAP11225	142	256	6.37
250	EFCAP11250	151	274	8.05
280	EFCAP11280	154	279	11.08
315	EFCAP11315	200	333	15.39

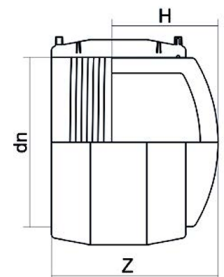
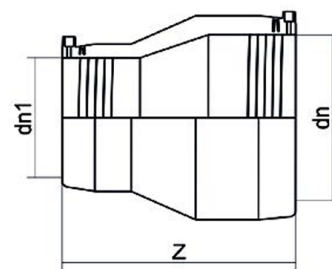

Top Loading Clamp for Electrofusion Branch Saddle

dn (mm)	dn1 (mm)	Code	Weight (kg)
315 - 400	200	EFTLC315/450-200	5.2
500 - 1200	200	EFTLC500/1200-200	5.2
315 - 1200	225	EFTLC315/1200-225	7.5
450 - 1200	250	EFTLC450/1200-250	8
560 - 1200	315	EFTLC560/1200-315	8



Electrofusion Tooling

IPLAST 105 Control Unit

Fittings Working Range	Code	Weight (kg)
20-1200mm	IPLAST105	24

Strengths:

- Able to weld fittings up to a diameter of 1600 mm
- Able to deliver constant power of 65A for 6 hours or 105A for a maximum time of 1400 seconds
- Safety output current system powered by a double insulation transformer with galvanic separation for maximum work safety at job site.



IPLAST 60 Control Unit

Fittings Working Range	Code	Weight (kg)
20-400mm	IPLAST60	18.5

Strengths:

- Able to weld fittings up to a diameter of 400mm
- Duty cycle @20°C: 100%=50A / 60%=70A / 30%=90A
- Degree of protection IP54. The casing design, made using the latest technology, ensures thorough cooling of electrical parts via a cooling fan.



IPLAST 30 Control Unit

Fittings Working Range	Code	Weight (kg)
20-160mm	IPLAST30	13

Strengths:

- Able to weld fittings up to a diameter of 160 mm
- Used in the construction of small pressurized water, gas and fluid systems.
- Supplied with universal adapters and a shoulder bag for easy transport



GWG Welding Wipes



Tool	Code
GWG Welding Wipes	EFWIPES



GWG WELDING WIPES

These specialised moist wipes are impregnated with a high specification solution containing 90% V/V Isopropyl Alcohol.

Ensure surfaces are clean before butt or electrofusion jointing (scraping of pipe surface is still required). 75 sheets per canister.



Electrofusion Tooling - Control Units

iPlast Control Units are the result of precise research at Plastitalia. They are made to make the welds of pipe and fittings for water and fuel gas more trustworthy and secure. The meticulous research and attention to detail have given life to this sophisticated device, whose internal control system and safety mechanisms are able to guarantee an optimal welding and in conditions of total safety for operators.

The new control unit, iPlast, houses a world-leading internal electronic unit, suitable for small dimensions — an outcome of a new generation of technological developments that Plastitalia, as first in the electrofusion fittings market, has brought.

Simple, intuitive interface iPlast has been designed for intuitive, straightforward use. The use of icons allows you to find all the information you need with a simple click.	Mechanical durability iPlast is the only welding machine in the world built with a die-cast aluminium frame for use in all types of work sites.	Made to keep going iPlast works longer than other welding machines because it has been designed to achieve maximum efficiency from energy exchange.	Can be used on any generator iPlast is built with 2 processors: one for the user interface and one for welding. For this reason, iPlast lasts to the end of the work day.
--	---	---	---

Control Unit iPlast 30 for Electrofusion Fittings

The iPlast 30 control unit is used for welding electrofusion fittings of small dimensions. As with other iPlast control units, it reflects the perfect combination of modern, practical design and sophisticated electronics. The minimization of components and an intensive use of digital processing techniques result in a highly advanced product, safe in all aspects and easy to use. iPlast is equipped with electronic controls that allow for rigorous verifications of welding processes.

Strengths:

- Able to weld fittings up to a diameter of 160 mm
- Used in the construction of small pressurized water, gas and fluid systems.
- Supplied with universal adapters and a shoulder bag for easy transport



Control Unit iPlast 60 for Electrofusion Fittings

Welding with an iPlast 60 control unit combines safety, reliability and working continuity, key points for the iPlast range. The efficient internal control system of the equipment constantly verifies all welding parameters, giving assurance about the optimum joint implementation. No need to cool down internal parts, even while working for long periods. Furthermore, the output circuit has been designed to protect you from potential risks, allowing you to weld in total safety.

Strengths:

- Able to weld fittings up to a diameter of 400mm
- Duty cycle @20°C: 100%=50A / 60%=70A / 30%=90A
- Degree of protection IP54. The casing design, made using the latest technology, ensures thorough cooling of electrical parts via a cooling fan



Control Unit iPlast 105 for Electrofusion Fittings

iPlast 105 is the new generation equipment born to make electrofusion welding of pipes and fittings, to be used in water and gas fuels, more secure. This new control unit has been designed to keep the whole welding process under control and to reduce risks connected to the job, meaning that your only task is the preparation of materials.

Strengths:

- Able to weld fittings up to a diameter of 1600 mm
- Able to deliver constant power of 65A for 6 hours or 105A for a maximum time of 1400 seconds
- Safety output current system powered by a double insulation transformer with galvanic separation for maximum work safety at job site.



The GWG Difference

For almost 40 years, Global Water Group (GWG) has been committed to meeting our customers' expectations and requirements with quality products and reliable service. We have experience in agriculture, aquaculture, farming, civil, mining, government and construction.

From design, sourcing, manufacturing and assembly through to packing, distributing and delivery, the GWG point of difference is **quality**. We service clients located throughout Queensland and Australia with our innovative product range and have earned our reputation for providing tailored solutions that reduce costs without compromising on quality or delivery.

Our Townsville and Brisbane warehouses are permanently stocked and our Townsville location features a fabrication facility, fully staffed by a team of highly experienced and qualified personnel.

We are your one-stop shop for everything polyethylene pipe and valves. Our wide range of products includes:

- Butt Weld, Electrofusion, Compression and BSP Fittings
- Butterfly Valves, Check Valves, Gate Valves and Ball Valves
- Backing and Blind Flanges (Galvanised and S/S)
- Gasket Sets
- PE Pipe (Blueline, All Black, Corrugated Stormwater)
- Machinery and Tooling Equipment (Electrofusion Machinery and Tooling, Pipe and Fitting Butt Welders, Pipe Cutting and Scraping Tools)

All of our products are Watermarked and made to Australian/New Zealand Standards. MDRs are available upon request.

Global Water Group



48 Keane Street, Currajong 4812, Queensland, Australia
25 Staple Street, Seventeen Mile Rocks 4073, Queensland, Australia
Townsville: (07) 4779 0173 | Brisbane: (07) 3517 5595
sales@gwgpoly.com.au
www.gwgvalvesandpoly.com.au